

Family Service League
Virtually Presents
The 28th Annual

GREAT CHEFS
Of Long Island



Monday, November 16, 2020

Honoring:

South Shore University Hospital - Northwell Health
Corporate Leadership Award

Paul Fleishman
Newsday's former Vice President of Public Affairs
Community Leadership Award



Welcome to the 28th Annual Great Chefs of Long Island Virtual Celebration

- 6:30pm Welcome:
 Karen Boorshtein, President & CEO
 Jonathan Chenkin, Vice President for Development
- Bid on our exciting auction prizes!
- Magic & Entertainment
- Award Presentations:
 Paul Fleishman
 Newsday's former Vice President of Public Affairs
 2020 Community Leadership Award
- South Shore University Hospital - Northwell Health**
 2020 Corporate Leadership Award
- FSL Video Presentation
- Sponsor Commercials and Thanks
- Musical Entertainment
- 7:20pm Closing Remarks
- 8:30pm Bidding Closes for Silent Auction

THANK YOU FOR YOUR SUPPORT!

BOARD OF DIRECTORS

Robert Creighton, Chair- *Farrell Fritz, PC*

Laura Granelli Gerde, Chair-Elect- *Jaspan Schlesinger LLP*

James Ashe, Vice-Chair of Finance and Audit- *Marcum LLP*

Jay B. Enden, M.D., Vice-Chair of Development-

South Shore University Hospital Northwell Health

Christine Malafi, Vice-Chair of Governance and Nominating-

Campolo, Middleton & McCormick, LLP

Dominique Walker, Vice-Chair of Programs-

South Shore University Hospital Northwell Health

Stephen Abramson

APS Pension Services, Inc.

Russell Albanese

Albanese Organization Inc.

Alberto J. Cassola

Publisher N2

Jon Cooper

Spectronics

Priscilla DiLello

TD Bank

Winston Dookram

State Farm Insurance

Sal Ferro

Alure Home Improvements

Richard Gavin

CAC Industries

Maggie Gilliam

Gilliam & Associates

Wayne Grossé

Bethpage Federal Credit Union

Elaine Kanas

Raynor Country Day School

Andrew L. Kaplan

New York Community Bank

Scott Maskin

SUNation Solar Systems, Inc.

Barbara Page

Community Leader

Katharine Posillico McGowan

Katharine Jessica Interior Design

Whitney Posillico

Community Leader

Robert Rowe

PSEG Long Island

Richard Jay Scholem

Community Leader

Joseph Shaffery

Community Leader

Scott J. Skorobohaty

Bank of America

David Sobocinski

UBS

Judith Sonfield

Community Leader

Kimberly Stevens

Douglas Elliman Real Estate

Chuck Tabone

Newmark Grubb Knight & Frank

Slava Vero

Community Leader

Francine Whitehead

Community Leader

Beth Zweig

Nassau Suffolk Law Services



*Robert Creighton
Board Chair*



*Karen Boorshtein
FSL President & CEO*

Welcome to the 28th annual Great Chefs of Long Island fundraiser. We appreciate you joining us virtually to share this special celebration. It is truly a privilege to have the opportunity to recognize distinguished honorees who have supported the FSL mission of service. Congratulations to Paul Fleishman and Northwell Health's South Shore University Hospital. This evening is made possible through the contributions of many. Our heartfelt appreciation goes to our dedicated Co-Chairs, Committee members, sponsors, and volunteers. These efforts have an impact on the care we provide to children and adults every day.

Although Long Island is considered by many to be affluent there are thousands of people enduring severe hardships - poverty, homelessness, struggling with the challenges of mental illness, or living with the destruction of addiction. All of these issues are exacerbated by the Covid-19 health emergency. For over 90 years, FSL has delivered tangible help and crisis intervention across a broad spectrum of areas offering education, support, medical care, and counseling services. During this critical time, our programs are more relevant than ever, and we thank you for your generous support. Together, we are making a difference in the lives of our neighbors. Your compassion and vision have been vital to our mission of helping to Restore Hope and Rebuild Lives.

Please accept our thanks for joining us and extending your hearts to help those less fortunate on their journey toward a better life!

South Shore University Hospital, formerly Southside Hospital

Proud Recipients of the Corporate Leadership Award



South Shore University Hospital, formerly Southside Hospital, is a 300-bed hospital with physicians, nurses and other clinical and ancillary staff who provide healthcare services in all medical specialties.

As Northwell's most eastern tertiary hospital and a Level II trauma center, they are an integral member of Long Island's South Shore community, providing quality care for over 100 years. With top rated physicians, leading-edge research and the most advanced technology, South Shore has put their hearts into building award-winning clinical programs including heart and lung, stroke, orthopedics, obstetrics and gynecology, in addition to many others. South Shore has been ranked as one of the 50 Best Hospitals in U.S. News and World Report for heart surgery, and its Centers of Excellence include Heart and Lung, Orthopedics, Neurosciences and Women's Health.

South Shore University Hospital has expanded its reach as a regional destination for high-quality care on Suffolk's south shore and is an important academic teaching center for the Donald and Barbara Zucker School of Medicine at Hofstra/Northwell, providing residency programs, fellowships training and medical student rotations in obstetrics/gynecology, emergency and family medicine.

"Rebranding Southside as South Shore University Hospital provides a platform to tell the hospital's story in a way that's unencumbered by perceptions of the distant past," said Donna Moravick, NP, referencing its status as a financially distressed hospital before it became a fully owned member of Northwell. "The name change represents an exciting milestone that positions the hospital for even greater success in the years ahead."

Leadership



**Donna Moravick, RN, NP,
MBA, Executive Director**



**Lenny Nartowicz, MBA
Deputy Executive Director**



**Jay B. Enden, MD
Regional Medical Director,
Eastern Region, Northwell
Health
Medical Director, South
Shore University Hospital**



**Jay Civello, RN
Chief Nursing Officer**



South Shore University Hospital

301 East Main Street

Bay Shore, NY 11706

General Information: (631) 968-3000

<https://southside.northwell.edu/>

COMMUNITY LEADERSHIP AWARD

PAUL FLEISHMAN



"Family Service League is consistently one of our region's most respected and effective organizations, so receiving this Community Leadership Award from FSL-LI is especially humbling. Long Islanders are indeed blessed to have this strong, smart and dynamic non-profit agency here in our community providing vital services to the people who need it most."

Paul Fleishman recently retired from Newsday after 23 years where he was Vice President of Public Affairs, wrapping up his career as an accomplished Long Island media executive with extensive experience across the broadcasting and publishing fields. At Newsday Paul managed community affairs, corporate communications and signature community programs such as the Newsday High School Marching Band Festival, High School awards programs, Life's Victories breast cancer awareness program and Newsday Charities, which conducts annual campaigns and makes sizeable grants to local organizations assisting at-risk children and families.

Paul began his media career as a news reporter/desk assistant at a small Freeport radio station in 1970. He spent the next 26 years in the Long Island radio business, ultimately as General Manager of WBAB and WBLI before joining Newsday.

Throughout his career Paul has been a supporter, leader and advocate for many community, non-profit and business groups. Since 1990, he has been on the Board of Directors of the United Way of Long Island, where he is also on the Board's Executive Committee and Chair of the Marketing Committee. He is on the Board of Directors and Executive Committee of Variety Child Learning Center in Syosset and the Advisory Board of SUNY/Old Westbury's School of Business. Over the years he and his broadcasting and Newsday teams have received numerous awards for public service, journalism, marketing and community affairs accomplishments.

Paul is a proud lifelong resident of Long Island, growing up in Long Beach and now living in Hauppauge with his family.

Great Chefs of Long Island Event Committee

Co-Chairs

Matthew Niegocki, *Prudential Financial Services*

Dennis Russo, *Russo Consulting*

Committee

Carrie Callegari, *FSL Volunteer*

Dale Cole, *Newsday*

Jo Ann Curcio, *Angelic Delights*

Jerry D'Antone, *TD Bank*

Nan Gerson, *Bethpage Federal Credit Union*

Carol Hammond, *BankUnited*

Steve Haweeli, *WordHampton Public Relations*

Adam Holtzer, *Connections for Hire*

Mimi Howard, *People's United Bank*

Barbara Page, *FSL Board Member*

Patricia Posillico, *FSL Volunteer*

Whitney Posillico, *FSL Board Member*

Katharine Posillico McGowan, *Katharine Jessica Interiors & FSL Board Member*

Alexa Raspanti, *Central Business Systems*

Kim Stevens, *Douglas Elliman Real Estate & FSL Board Member*

Bob Trenkle, *USI Insurance Services LLC*

Tiffany Tuzzolo, *Hotel Indigo*

Karen Vito, *Cactus Salons & Spas*

Lisa Walsh, *FSL Volunteer*

Francine Whitehead, *FSL Board Member*

Thank you to our Great Chefs of Long Island Sponsors

Event Sponsor:



Sommelier Sponsors:



John & Elaine Kanas
Family Foundation

Connoisseur Sponsors:

Kathleen King



Bon Vivant and Foodie Sponsors:

Kaufman Family



Teig Family



Gerde Family



Callegari Family



Eileen & George Gardella



Walker Family



Rover 2014, LLC

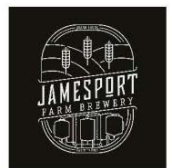

PROGRAMS & SERVICES

Children Services

- Alternatives For Youth (AFY)
- Autism Respite
- Autism Social Skills
- Bethpage Backpacks
- CAMP-Send a Child to Summer Camp
- Children and Family Treatment & Support Services
- Children's Care Coordination / Health Home
- Children's Waiver Services
- Cognitive Behavioral Intervention for Trauma in Schools
- Community Home Base
- Home Base I/CCSI
- Kornreich Early Learning Center
- Learn, Enrich, Achieve and Dream
- Lockwood Early Learning Center
- Operation Success
- Project TOY
- RECESS
- Universal Pre-Kindergarten



Crisis & Trauma Services

Crisis HOTLINE 631-952-3333

- Center of Treatment Innovation (COTI)
- Community Crisis Action Team (C-CAT)
- Diagnostic and Assessment Stabilization Hub (DASH)
- Joe's Project
- Mobile Crisis Team

Education & Employment Services

- Continuing Education Courses
- Flexible Employment Program
- Supported Employment Demonstration Project
- WorkPlus
- YouthBuild

Addiction Services

- ADAM - Addiction Direction and Management
- Alcohol and Drug Prevention
- Center of Treatment Innovation (COTI)
- Chemical Dependency Clinics
- Diagnostic Assessment and Stabilization Hub (DASH)
- LI Prevention Resource Center
- Mobile Crisis Team





Family & Community Services

Brentwood Community School
Community Advocacy, Information & Referral (CAIR)
Community Behavioral Health Collaborative (CBHC)
East End Youth and Family Advocacy
Family Connect
Genoa Pharmacy (partner)
Healthy Families New York
Home Safe
Library Family Place
Parent To Parent
WIC – Women, Infant, Children Stony Brook (partner)

Housing & Homeless Services

Emergency Housing Family Shelter
Homeless Prevention and Rapid Rehousing
HomeShare Long Island
Huntington Interfaith Homeless Initiative (HIHI)
Program Home
South Shore Family Shelters
Suffolk Hope – Supported Housing
The Linkage Center and Extension (TLC)



Mental Health & Integrated Care Services

Assertive Community Treatment (ACT)
Certified Community Behavioral Health Care Clinic (CCBHC)
Child Mobile Clinic
Children and Family Treatment & Support Services
Children and Parents Together
Children's Waiver Services
Community Crisis Action Team (C-CAT)
Community Health Care Collaborative (CHCC)
Diagnostic Assessment and Stabilization Hub (DASH)
Fay J. Lindner Health & Wellness Center
Genoa Pharmacy (partner)
Health Home Care Management
Joe's Project - Post Suicide Counseling
Mental Health Clinics and Satellites
Mobile Crisis Team
Stepping Stones Personal Recovery Oriented Services (PROS)
Transition of Care - Northwell Health System and Stony Brook University Hospital



Senior & Caregiver Services

Caregiver Support
Geriatric Waiver: Nursing Home Transition and Diversion
HomeShare Long Island
Long Island Sound Senior Connections (LISSC)
Long Term Care Ombudsman
SeniorNet Computer Learning Center

Mission

Family Service League
helps individuals, children, and families
to mobilize their strengths and
improve the quality of their lives
at home, in the workplace, and in the community.

Executive Staff

Karen Boorshtein, LCSW	<i>President & CEO</i>
Jeff Steigman, Psy. D	<i>Chief Administrative & Innovation Officer</i>
Shari Feld, MS	<i>Chief Financial Officer</i>
Nancy Jacob, MPS	<i>Chief Human Resources Officer</i>
Robert Moerland, MS,PMP,ITIL	<i>Chief Information & Security Officer</i>
Craig Greenfield, Esq.	<i>Chief Legal Officer</i>
Kathy Rosenthal, LCSW	<i>Senior Vice President for Programs</i>
Margaret Boyd, LMSW	<i>Vice President for Community Services & Advocacy</i>
Jonathan Chenkin, BS	<i>Vice President for Development</i>
Larry Daniels, MA	<i>Vice President for Operations</i>
Lori Anne Brennan, LMSW	<i>AVP for Clinical Compliance & Community Behavioral Health</i>
Valerie Chamberlain, LCSW	<i>AVP for Housing & Homeless Services</i>

Program Administrators and Directors

Robyn Berger-Gaston, LCSW	
Melissa Coscia, LCSW	Lisa Jamison, LMSW
Patricia Ferrandino, LCSW	Fran Mellow, LCSW-R
Erik Fink, MD	Christian Racine, Ph.D.

Development Department

Jonathan Chenkin, *Vice President for Development*
Michelle Buckle, *Coordinator for Volunteer Services*
Jennie Sandler Fiocca, *Director of Development*
Sandra Levine, *Director of Grants & Program Development*
Tricia O'Hare, *Director of Development & Communications*
Kim Tucker, *Development Operations Manager*

Bethpage is proud to support

Family Service League

and the Great Chefs of Long Island.

*Congratulations to
our friend, Paul Fleishman
and Northwell South
Shore University Hospital!*



**For more information, visit
lovebethpage.com.**



Federally
Insured
By NCUA

Bethpage 
Federal Credit Union

THE JOHN & ELAINE KANAS
FAMILY FOUNDATION

PROUDLY SUPPORTS

FAMILY SERVICE LEAGUE

AND

APPRECIATES THE FSL STAFF,
MEDICAL PROFESSIONALS, AND FIRST
RESPONDERS WORKING TO KEEP OUR
COMMUNITY SAFE AND HEALTHY!



CONGRATULATIONS
TO THE HONOREES
PAUL FLEISHMAN

AND

SOUTH SHORE UNIVERSITY HOSPITAL
NORTHWELL HEALTH

RAYNOR COUNTRY DAY SCHOOL & SUMMER CAMP

**Apply now for Pre K - - 6th Grade
& Summer Camp!**

Small Class Sizes

Differentiated Academic Instruction

World Languages

Manners/Etiquette

Chorus & Instrumental

Jazz Band & Ukulele

Musical Theatre for all Students

Fine Arts & Dance Program

Physical & Character Education

Before- & After-School Programs



Character

Culture

Community!



**See what all
the buzz is
about!**

Private School Makes A Difference

P.O. Box 380, Westhampton

Visit our Facebook Page: [RaynorCountryDaySchoolandCamp](#)

631.288.4658

Limited scholarship program available to qualified applicants



A new name. A new experience.

Southside Hospital is becoming South Shore University Hospital

Transformation is profound change. The kind you can see and experience. It's facilities, remodeled. Top doctors, recruited. And capabilities, reimagined.

It's making vital updates to safely and effectively care for our community. So whether we treat your heart, your brain—or your loved one—you'll know you're in the very best hands.

South Shore University Hospital will be much more than a rename; it's an entirely transformed experience—coming January 2021.



South Shore University Hospital
Northwell Health®

AvalonBay Congratulates Tonight's Honorees

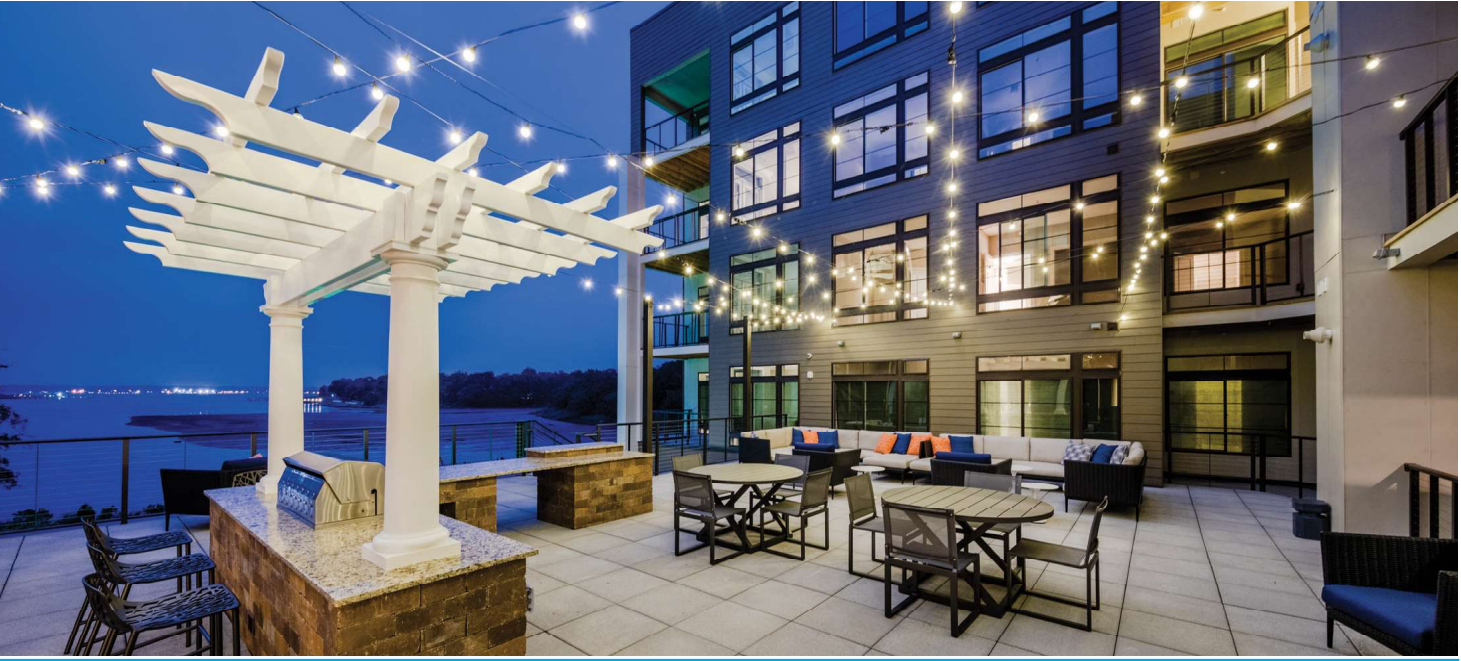

AVALON GREAT NECK
NOW OPEN

AVALON HARBOR ISLE
COMING SOON



Avalon currently has 9 rental communities on Long Island.
For information on these and other rental communities nationwide, visit:
[AvalonCommunities.com/Long-Island-Apartments](https://www.AvalonCommunities.com/Long-Island-Apartments)

AvalonBay
COMMUNITIES

Thank you to
Family Service League
and the 2020 Great Chefs Honorees

South Shore University Hospital
Northwell Health
2020 Corporate Leadership Award

Paul Fleishman
Newsday's former Vice President of Public Affairs
2020 Community Leadership Award

Kathleen King



Alice and Jaclyn Houseknecht
Foundation proudly supports
Family Service League!

Alice Houseknecht, Founder
Jaclyn Houseknecht, Director

Accumedic
is proud to Support
Family Service League!



Innovative Software Solutions for the Healthcare Industry



ALBANESE
ORGANIZATION, INC.

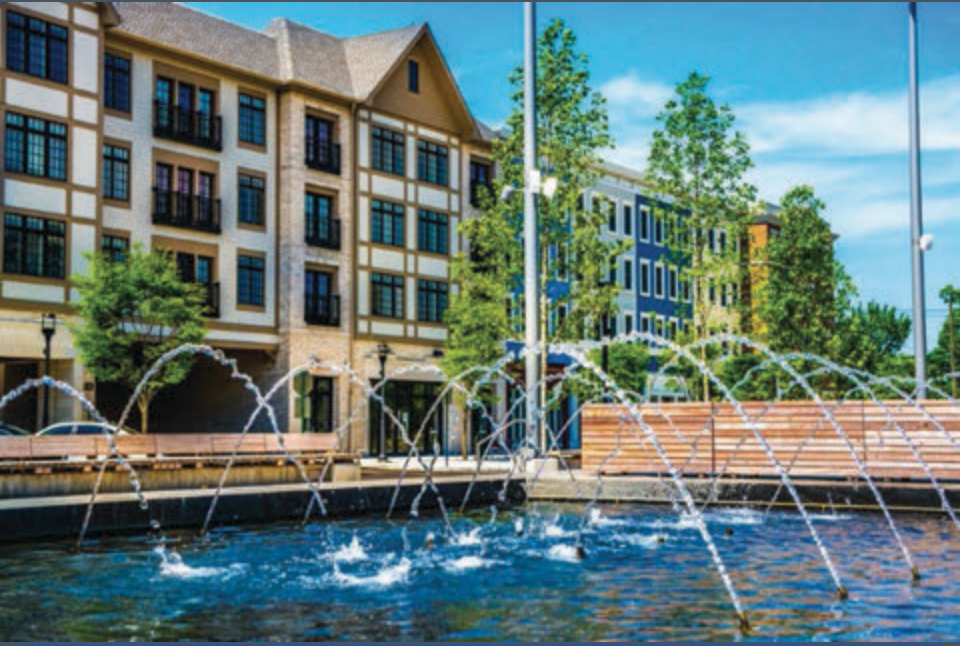

We proudly support
**Family Service League's
Great Chef's of Long Island**
& congratulate this year's Honorees

**South Shore University Hospital
Northwell Health**

**Paul Fleishman,
Newsday's former VP of Public Affairs**

Our thanks and
appreciation
to all the volunteers
and staff at
Family Service League

- Carrie and Greg Callegari

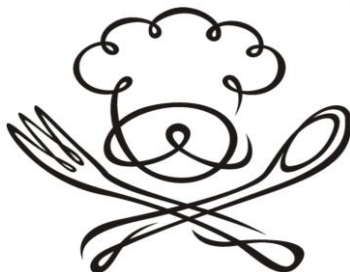



Central Business Systems



SHARP



Canon

EPSON

 **Lexmark**



Proud Supporters of Family Service League

Freedom of Choice

Over  **70** Years of Service Excellence



Copiers • Printers • Scanners
Managed IT Services • Managed Print Services • Document Management Systems



For More Information Call: (631) 249-1990
Email: info@centraldigitalsolutions.com
Or Visit Our Website: www.centraldigitalsolutions.com

Member of the Better Business Bureau with an A+ Rating



Farrell Fritz
proudly supports
Family Service League

We join in honoring
South Shore University Hospital -
Northwell Health
and
Paul Fleishman



Our thanks to
Family Service League
for all that you do.

Congratulations the 2020 Honorees,

South Shore University Hospital
Northwell Health
2020 Corporate Leadership Award

Paul Fleishman
Newsday's former Vice President of Public Affairs
2020 Community Leadership Award



Challenges are everywhere. So are solutions.

For more information, contact
Gallagher at 516.333.8787

ajg.com



Gallagher

Insurance | Risk Management | Consulting

*We are proud to support
Family Service League.*

*Thank you for all you do to
strengthen our community.*



Eileen and George Gardella

We're here for you.

Genoa Healthcare® pharmacy services can support you and your consumers with:



Free medication mailing
or curbside pick-up



Assistance with prior
authorizations



Medication adherence rates
of 90%

Learn more at www.genoahealthcare.com.

genoa
healthcare®

LAURA AND ERIC GERDE
ARE PROUD TO SUPPORT
FAMILY SERVICE LEAGUE

AND THE
PEOPLE THEY SERVE.

CONGRATULATIONS TO THE
2020 HONOREES!



**Congratulations
to the 2020 Honorees,**

**South Shore University Hospital
Northwell Health
&
Paul Fleishman**



Katharine Jessica Interior Design

631.418.8491

www.kj-id.com

kjm@kj-id.com

Congratulations to
Family Service League
on a successful Great Chefs
and thank you to the honorees
and the committee for their
commitment to the people
FSL serves.

-Lynn and Jonah Kaufman



LincolnIT is Proud to Sponsor Family Service League's
Great Chefs of Long Island

V I R T U A L F U N D R A I S E R



CONGRATULATIONS TO

South Shore University Hospital
Northwell Health, Corporate Leadership Award;
and Paul Fleishman, Community Leadership Award;
as this year's honorees.

We would like to recognize and thank these leaders for their tireless efforts in helping and supporting Long Island residents impacted by the COVID-19 health pandemic.

Hicksville • New York City • East Hampton

We Commend
Family Service League
For Its Tireless Commitment and Dedication to
Improving the Lives of Others
and
Proudly Support Its
2020 Great Chefs
Congratulations to All of This Year's Honorees

Seth P. Stein, Esq.



**Moritt Hock
& Hamroff^{LLP}**
ATTORNEYS AT LAW

STRENGTH IN PARTNERSHIP[®]

Garden City | 516.873.2000

New York City | 212.239.2000

www.morithhock.com

Mutual of America
Salutes
Family Service League

*for their commitment to
delivering much needed
support and crisis intervention
across a spectrum
of service areas*



Mutual of America
Financial Group SM

Retirement Services • Investments

We Proudly Salute
~Family Service League~
***On Their Annual Great Chefs of
Long Island Event***

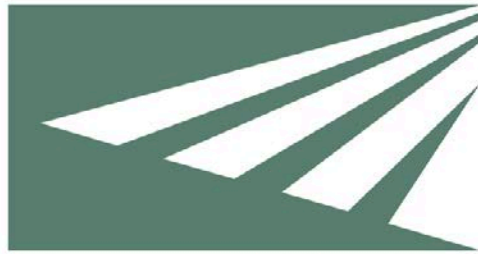

NawrockiSmith

**CERTIFIED PUBLIC ACCOUNTANTS
&
BUSINESS CONSULTANTS**

290 Broad Hollow Road
Suite 115E
Melville, NY 11747
Telephone 631-756-9500
Facsimile 631-756-9818
Website www.nslpcpa.com



**Newmark
Knight Frank**

A SPECIAL HONOR

We proudly support

Family Service League

in its

Great Chefs Fundraiser

and are pleased to congratulate

South Shore University Hospital - Northwell Health

and Paul Fleishman for their commitment to building
outstanding communities in Long Island.

Newsday Salutes

Family Service League

for its dedication and service to the Long Island community.

CONGRATULATIONS

TO THE 2020 HONOREES:

South Shore University Hospital - Northwell Health

Corporate Leadership Award

Paul Fleishman
Newsday's former VP Public Affairs

Community Leadership Award



We are proud to support the

Family Service League

Great Chef's of Long Island

With practical knowledge and uncommon expertise, our bankers address your financial needs with solutions that matter to you.



What know-how can do®

Let's Talk.

Steven Santino
SVP, Senior Growth Manager
Retail Banking
631-416-3576

William Vrana
VP, Not for Profit Banking
631-637-3721

Posillico

We know how.



1750 New Highway
Farmingdale, NY 11735

631.249.1872
www.posillicoinc.com



Civil | Materials | Environmental | Paving | Drilling | Utilities | Consulting | Development

Proud Supporters of
Family Service League

The John A. Rodger Jr. Foundation Inc.

**In Recognition of
FAMILY SERVICE LEAGUE**

**Doing Great Work
on behalf of humanity**

**A Proud Sponsor
Rover 2014, LLC**

Signature Bank
is proud to support
the invaluable work that
FAMILY SERVICE LEAGUE
provides to the community.



SIGNATURE BANK®

Alan Giaimis
Group Director – Senior Vice President
(631) 962-7370
AGiaimis@signatureNY.com

360 Motor Parkway, Suite 150, Hauppauge, NY 11788

Congratulations to
Family Service League
for all the wonderful work
that you do.

From,
The Medical Board of
South Shore University Hospital





Suffolk Transportation Service, Inc.

A Tradition of Excellence since 1922

***A Partnership in Safety.
A Commitment to Our Employees.***



We thank our employees for their award winning dedication to providing the safest transportation to all riders.



For Employment Opportunities Call or visit us on-line

10 MOFFITT BLVD., BAY SHORE, NY 11706 • 631.665.3245 • suffolkbus.com



**Thanks for making a difference.
It's an honor to celebrate the things
that bring our community together.**



America's Most Convenient Bank®

Congratulations

to

Family Service League

&

The 2020 Honorees

Judi and Howard Teig

CONGRATULATIONS
TO THE HONOREES

THANK YOU TO
FAMILY SERVICE LEAGUE
FOR THEIR CONTINUOUS HARD WORK
AND THE DIFFERENCES THEY MAKE
IN THE COMMUNITIES THEY SERVE.

CONGRATULATIONS FROM,
EMMETT, BETTY,
DOMINIQUE, & BRITTANY WALKER

*Our thanks to the
dedicated committee members
and the 2020 Honorees,*

**South Shore University Hospital
Northwell Health**
2020 Corporate Leadership Award

Paul Fleishman
Newsday's former Vice President of Public
Affairs
2020 Community Leadership Award

Fran & Brian Whitehead

Honoring Karen Boorshtein
and all the employees of
Family Service League
who are working so successfully
during the pandemic to
Restore Hope and Rebuild Lives.

We Salute You!!
Barbara Page and John Finan

*Congratulations to
Family Service League,
the honorees,
and all the volunteers
who made
Great Chefs possible!*

-Rick Gavin

5873 Sound Avenue, Riverhead, NY 11901

844-JFB-BEER • jfbrewery.com



Savor artisan beer in our historic potato barn tasting room or stroll outside to our expansive lawn with views of hop bines and sunflowers. Experience quality craft beer brewed on site with ingredients grown on our farm.

CONGRATULATIONS TO OUR 2020
SELECTED CHARITY FROM THE
WOMEN'S MONTH INITIATIVE

FAMILY SERVICE LEAGUE

PROCEEDS WERE DONATED FROM THE SALES OF
LUNAR ASCENT IPA AND FUNDRAISING EVENTS
HOSTED AT PARTICIPATING BREWERIES



**NORTH
FORK**
BREWING CO



LADYBREWSTERS.COM
@LADYBREWSTERS



NORTH FORK
BREWING CO

**Beer and community
go hand in hand.
We are honored to serve
our community in need
by giving back.**

*Dedicated to creating craft beer
anchored in our rich North Fork
traditions of agriculture, hard work,
and good times*

**24 E 2ND STREET, RIVERHEAD, NY
NOFOBREWCO.COM
@NORTHFORKBREWINGCO**



keeping the world
crafty and supporting
those in need

übergeek

riverhead, new york
ubergeekbrewing.com
@ubergeekbrewing



*Please Support the Restaurants who have supported us!
We cannot wait to be back together next year!*



110 Japan: www.110japan.com

All Star Specialties: www.allstarspecialties.net

American Classic Ice Cream: www.americanclassicicecream.com

Arden Temptations: www.ardentemptations.com

BabaluNY: www.babaluny.com

Bango Bowls: www.bangobowls.com

Bella Vie: www.thebellavie.com

Besito Mexican: www.besitomexican.com

Chef Chris LaVecchia: www.ChefChrisLaVecchia.com

Chris & Tony's: www.chrisandtonys.com

City Cellar American Modern: www.citycellarny.com

Creme Allure: www.cremeallure.com

Crest Hollow Country Club: www.cresthollow.com

Epicure Bistro: www.epicureny.com

Grasso's: www.grassosrestaurant.com

Hometown Bake Shop: www.hometownbakeshop.com

Jonathan's Ristorante: www.jonathansristorante.com

Kellys Karmic Confections: www.kellysconfections.com

Kingfish Oyster Bar: www.kingfishoysterbar.com

Limani: www.limani.com

Lulu Kitchen: www.lulusagharbor.com

North Fork Chocolate Company: www.NorthForkChocolate.com

North Fork Doughnut Company: www.nofodoco.com

Osteria Da Nino: www.osteriadanino.com

Piccolo Mondo www.piccolomondoli.com

Red: www.redrestaurant.com

Restaurant LOLA: www.restaurantlola.com

River Road Bistro: www.riverroadoysterbay.com

Roast: www.roastsandwichhouse.com

Saaz... The Symphony of Spices: www.saazindian.com

Sage Bistro Moderne: www.sagebistromoderne.com

Season's 52: www.seasons52.com

Seven Quarts Tavern: www.sevenquartstavern.com

Sexy Salad: www.thesexysalad.com

Spuntino Wine Bar & Italian Tapas: www.spuntinowinebar.com

The Brass Rail: www.TheBrassRailLocustValley.com

The View Grill: www.viewgrill.com

Tocolo Cantina: www.tocolocantina.com

Vauxhall: www.vauxhallhuntington.com

